



MEETING SPACE	DIMENSIONS	SQ. FT.	CEILING	U-SHAPE	HOLLOW SQUARE	CONFERENCE	CLASS ROOM	THEATER	ROUNDS	SEMI-ROUNDS
---------------	------------	---------	---------	---------	---------------	------------	------------	---------	--------	-------------

South Wing

Lakeside Room	56 x 74	4144	9'3"-12'11"	40	50	-	170	300	250	125
Oak	39 x 19	741	11'9"	18	20	20	30	40	32	16
The Woodlands Ballroom Section I	60 x 50	3000	15'4"-18'3"	46	58	-	140	300	220	110
The Woodlands Ballroom Section II	60 x 50	3000	15'4"-18'3"	46	58	-	140	300	220	110
The Woodlands Ballroom Sections I & II	60 x 100	6000	15'4"-18'3"	78	94	-	280	600	450	225
Pines (L. Shape)	29'6" x 23'4" 15' x 24'3"	1,068	8'9"	20	24	28	40	84	48	36
Magnolia	34 x 27	918	12'	18	24	20	36	50	48	24
Sycamore (Lower Level)	34 x 27	918	9'3"	18	24	20	36	50	48	24
Wharf Terrace	64 x 27	1728	-	-	-	-	-	-	180	90
Hawthorne	33 x 27	891	12'	18	24	20	36	50	48	24
Cypress (Lower Level)	33 x 28	924	9'3"	18	24	20	36	50	48	24
Evergreen	30 x 23	690	13'5"	16	18	20	24	40	40	20
Willow	28 x 43	1204	13'5"	24	30	20	50	64	64	32

North Wing (First Floor)

Grand Ballroom Section I	85 x 49	4165	23'	64	85	25+	160	336	280	140
Grand Ballroom Section II	85 x 60	5100	23'	68	90	25+	220	450	350	175
Grand Ballroom Section III	85 x 49	4165	23'	64	85	25+	160	336	280	140
Grand Ballroom Sections I, II, & III	85 x 158	13,430	23'	-	-	-	560	1240	980	490
Guest House Board Room	15 x 25	375	6'9"	-	-	16	-	-	-	-
Terrace North	20 x 33	660	10'8"	-	-	-	-	-	44	22
Terrace South	19 x 29	551	10'8"	-	-	-	-	-	24	12
Forest Deck	59 x 52	3068	-	-	-	-	-	-	350	175

North Wing (Second Floor)

Emerald Ballroom I	30 x 60	1800	10'6"-22'1"	-	-	-	-	-	120	60
Emerald Ballroom II	34 x 60	2040	10'8"-22'1"	-	-	-	-	-	130	65
Emerald Ballroom I & II	64 x 60	3840	10'8"-22'1"	-	-	-	-	-	250	125
Rio Grande West	38 x 29	1102	8'-15'1"	24	30	20	48	75	64	32
Rio Grande Center	38 x 32	1216	15'1"-20'10"	24	30	20	48	75	64	32
Rio Grande East	38 x 29	1102	8'-15'3"	24	30	20	48	75	64	32
Rio Grande Ballroom	38 x 90	3420	8'-20'8"	50	60	-	120	200	180	90
Houston	40 x 54	2160	11'-14'	40	45	20	100	150	100	50
Mexico	20 x 25	500	11'1"	12	14	14	18	25	16	8
Crockett	29 x 39	1131	11'-14'2"	24	28	20	50	70	48	24
French	29 x 49	1421	8'6"-17'1"	32	36	20	60	80	72	36
Austin	29 x 39	1131	11'-14'2"	24	28	20	50	70	48	24
Texas	20 x 25	500	11'1"	12	14	14	18	25	16	8
Republic	39 x 34	1326	11'-12'5"	27	32	20	50	70	72	36
Spanish	39 x 34	1326	11'-12'5"	27	32	20	50	70	72	36
Spanish/Republic	39 x 68	2652	11'-12'5"	48	56	-	100	180	144	72
States	19 x 34	646	17'2"-18'	16	18	16	28	40	24	12
San Felipe	30 x 29	870	16'10"-17'2"	20	24	20	32	60	40	20
San Jacinto	30 x 29	870	16'10"-17'2"	20	24	20	32	60	40	20
Travis	19 x 34	646	17'2"-18'	16	18	16	28	40	24	12
Vista Dining	32 x 34	1088	12'	32	38	20	50	120	50	25
Vista Lounge	44 x 25	1100	12'	-	-	-	-	-	64	32

*Capacities are based on maximums, not including AV, catering requirements, etc.

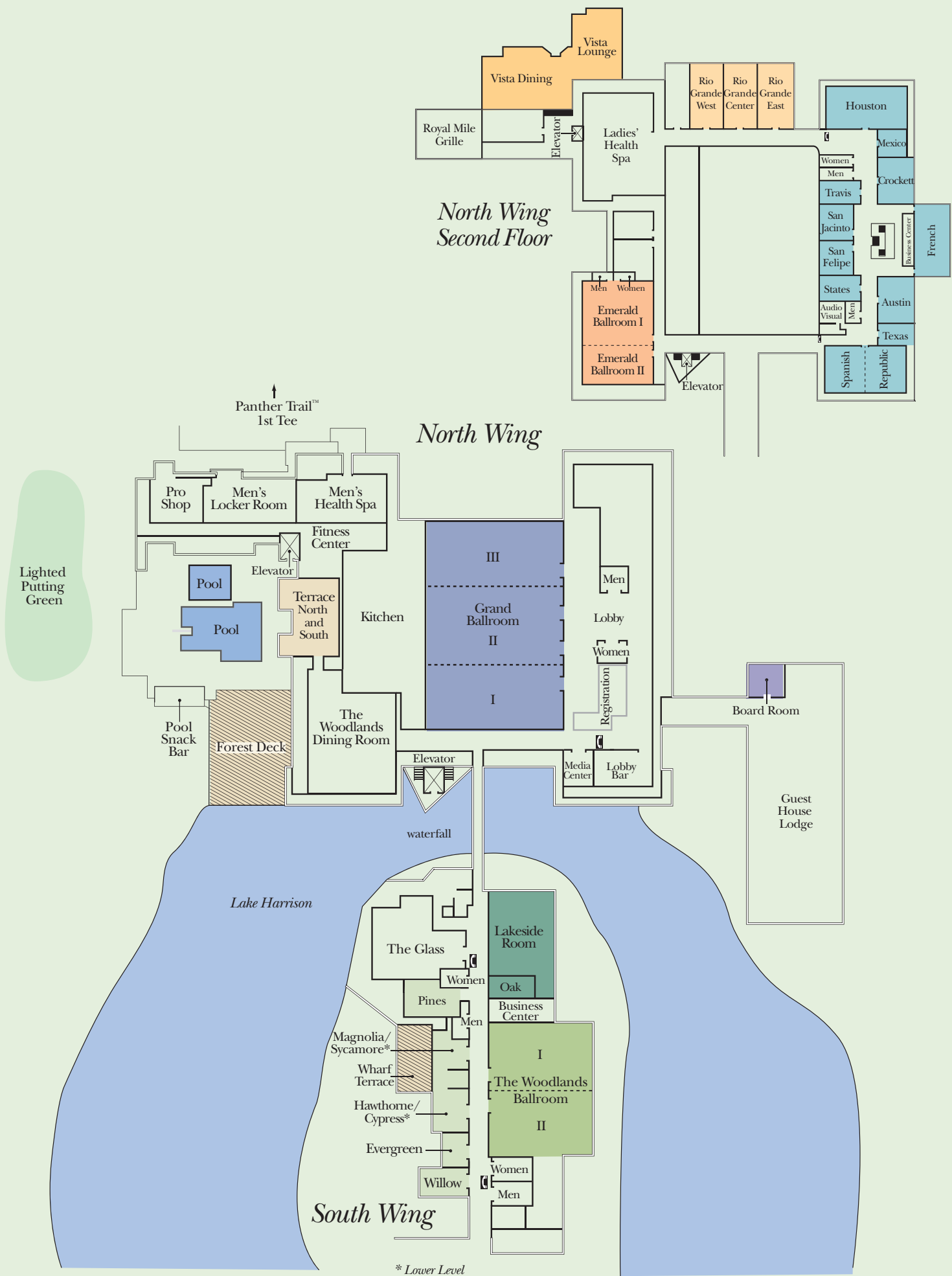

Lighted Putting Green

* Lower Level